



84 Addycombe Terrace, Newcastle Upon Tyne, NE6 5SQ

£1,150 Per Month

Available June 2026 | £1,150 per month | Hive Estates welcomes to the market this stunning two bedroom flat in Heaton. With open-plan living space and a contemporary kitchen, there are two double bedrooms, one featuring a beautiful bay window, with a stylish and sophisticated colour palette throughout.

Situated on Addycombe Terrace in Heaton, this immaculately presented home is close to local transport links, shops and amenities nearby. Upon entering the property you are welcomed into a carpeted entrance hallway which features a storage cupboard and leads through to the main living space. The living area is generous in size and has been converted into an open-plan space, with a wide archway opening into the modern kitchen complete with integrated appliances, metro-style tiling and bold contrasting walls to complement the deep green of the living room. There is wood-effect laminate flooring throughout the space, with the living room featuring stylish contemporary light fittings. To the rear of the property is the modern shower room with metro style tiling, black framed shower screen, patterned floor tiles, matt black heated towel ladder and a three-piece suite. There are two beautifully finished double bedrooms, the main bedroom featuring bay window, period coving and ceiling rose. Decorated to a very high standard throughout, the property benefits from gas central heating, double glazing and a private rear yard.

Kitchen 9'10" x 8'1" (3.0 x 2.48)

Living Room 14'2" x 13'7" (4.33 x 4.15)

Bedroom 1 16'0" x 13'1" (4.88 x 4.0)

Bedroom 2 9'8" x 8'5" (2.96 x 2.57)

Shower Room 7'8" x 4'0" (2.35 x 1.24)

Floor Plan

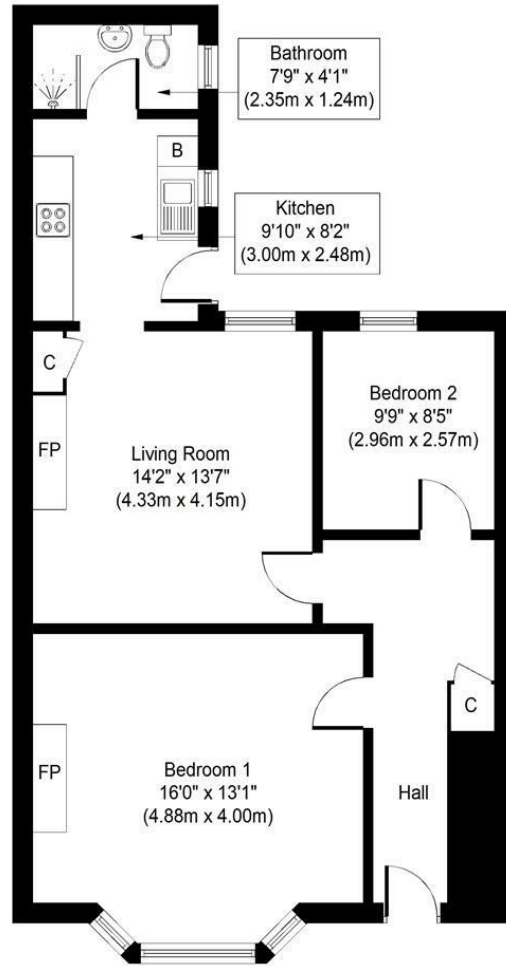

Approximate Floor Area
743 Sq. ft.
(69.0 Sq. m.)

Whilst every attempt has been made to ensure the accuracy of the floor plan contained here, measurements of doors, windows, rooms and any other items are approximate and no responsibility is taken for any error, omission, or mis-statement. This plan is for illustrative purposes only and should be used as such by any prospective purchaser or tenant. The services, systems and appliances shown have not been tested and no guarantee as to their operability or efficiency can be given. Copyright V360 Ltd 2021 | www.houseviz.com

Area Map

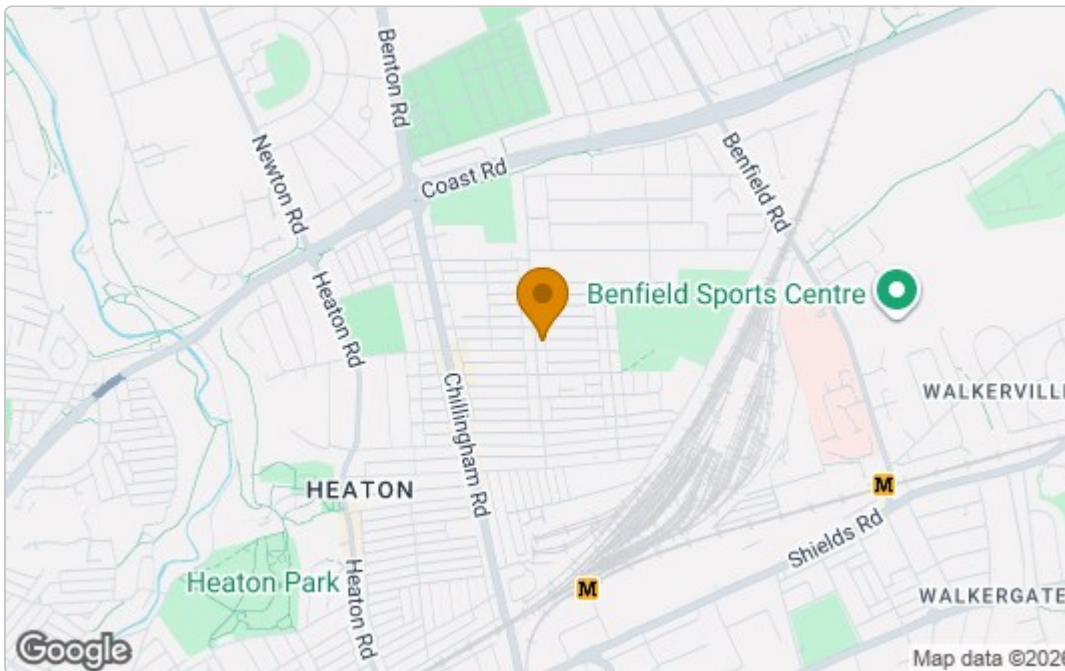

Energy Efficiency Graph

Energy Efficiency Rating		Current	Potential
Very energy efficient - lower running costs			
(92 plus) A			
(81-91) B			
(69-80) C			
(55-68) D			
(39-54) E			
(21-38) F			
(1-20) G			
Not energy efficient - higher running costs			
		67	74
England & Wales		EU Directive 2002/91/EC	
Environmental Impact (CO ₂) Rating		Current	Potential
Very environmentally friendly - lower CO ₂ emissions			
(92 plus) A			
(81-91) B			
(69-80) C			
(55-68) D			
(39-54) E			
(21-38) F			
(1-20) G			
Not environmentally friendly - higher CO ₂ emissions			
England & Wales		EU Directive 2002/91/EC	

These particulars, whilst believed to be accurate are set out as a general outline only for guidance and do not constitute any part of an offer or contract. Intending purchasers should not rely on them as statements of representation of fact, but must satisfy themselves by inspection or otherwise as to their accuracy. No person in this firm's employment has the authority to make or give any representation or warranty in respect of the property.